

ELECTIONS BC
A non-partisan Office of the Legislature

ABBOTSFORD-MOUNT LEHMAN

Electoral District Redistribution 1999
The electoral district and voting area boundaries that are contained on this map sheet are effective upon dissolution of the 39th Parliament of British Columbia

Legend

See Map B

SPECIAL VOTING AREAS

VA Name	Street	City
23s	Harbour Lodge	Any Town
25	Maple Town Apartments	Any Town

PORT VOTING AREAS

VA Name	Street	City
23s	Harbour Lodge	Any Town
25	Maple Town Apartments	Any Town

Electoral district map sheet key

Use the following map and list to determine the appropriate map sheet for a city, town or region.

- Example List:**
- West part of district
 - East part of district
 - MAP A - West Town 1 & Town 2
 - MAP B - East Town 1, Town 2
 - MAP C - City Region North
 - MAP D - City Region South
 - MAP E - City Region

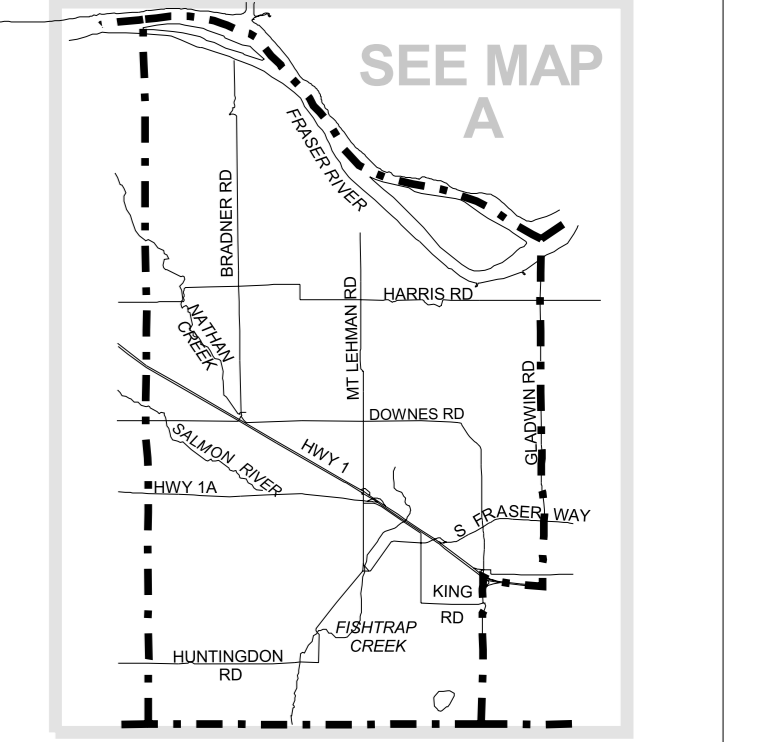

MAP A - Overview
MAP B - Abbotsford

Map sheet number

- Example: VFA.D.R1999.BS3-01.20000524
- VFA - Electoral District code
 - B - Map sheet letter
 - 010509 - Year of electoral district redistribution
 - BS3 - Boundary Set number
 - 01 - Map sheet version number
 - 20000524 - Map sheet production date

Map sheet(s) within this electoral district

ABM.A.R1999.BS3-01.20001016
ABM.B.R1999.BS3-01.20010212

1	A	46	B	87	B
2	A	47	B	88	B
3	A	48	B	89	B
4	AB	49	B	90	A
5	A	50	B	91	A
6	A	51	B	92	A
7	A	52	B	93	A
8	AB	53	B	94	A
9	AB	54	B	95	A
10	AB	55	B	96	A,B
11	AB	56	B	97	B
12	AB	57	B	98	B
13	B	58	B	99	B
14	B	59	B	100	B
15	B	60	B	101	B
16	B	61	B	102	B
17	B	62	B	103	B
18	B	63	B	104	B
19	B	64	B	105	B
20	B	65	B	106	B
21	B	66	B	107	B
22	B	67	B	108	B
23	B	68	B	109	B
24	AB	69	B	110	A
25	AB	70	B	111	A
26	AB	71	B	112	A
27	AB	72	B	113	A
28	AB	73	B	114	A
29	AB	74	B	115	A
30	AB	75	B	116	A
31	AB	76	B	117	A
32	AB	77	B	118	A
33	AB	78	B	119	A
34	AB	79	B	120	A
35	AB	80	B	121	A
36	AB	81	B	122	A
37	AB	82	B	123	A
38	AB	83	B	124	A
39	AB	84	B	125	A
40	AB	85	B	126	A
41	AB	86	B	127	A
42	AB	87	B	128	A
43	AB	88	B	129	A
44	AB	89	B	130	A
45	AB	90	B	131	A

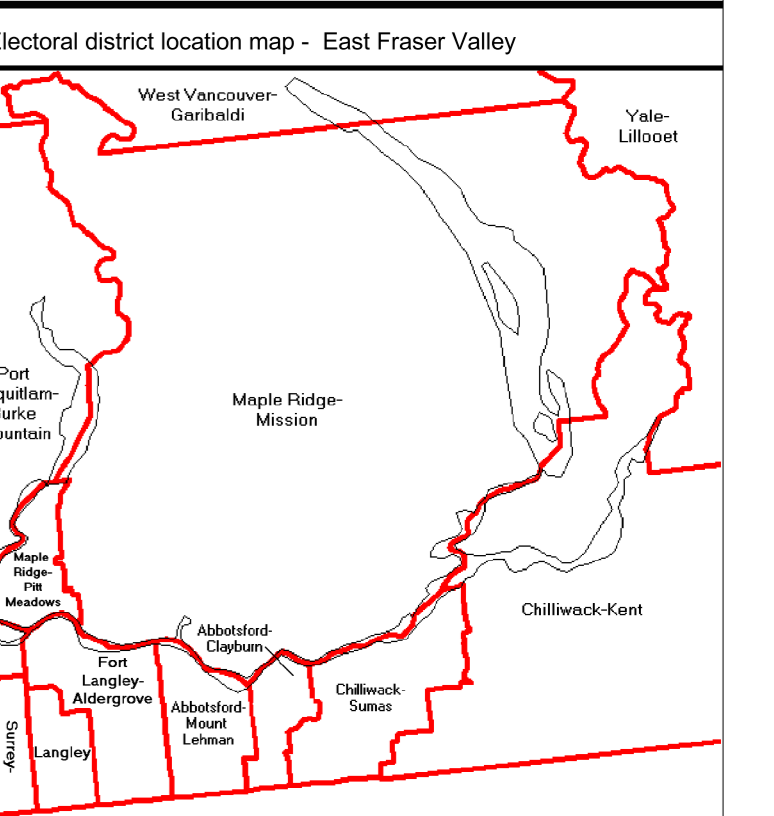

Electoral District location map - East Fraser Valley

Electors BC
Toll Free: 1-800-661-8883
Email: ElectionsBC@gems3.gov.bc.ca
Web Site: www.elections.bc.ca

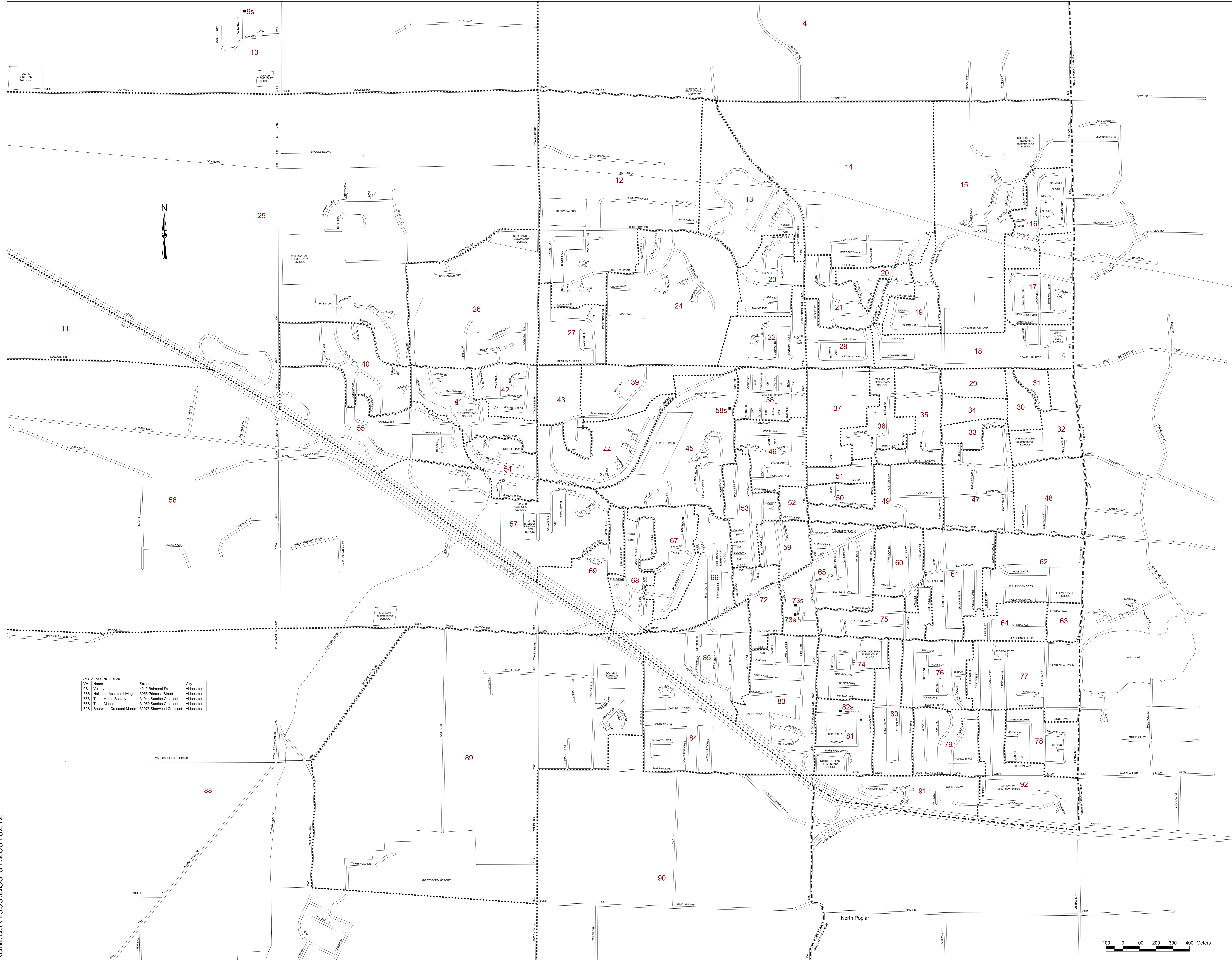

SPECIAL VOTING AREAS

VA Name	Street	City
95	Valhalla	Abbotsford
96	Haltmark Assisted Living	Abbotsford
73s	Tabor Home Society	Abbotsford
73s	Tabor Manor	Abbotsford
82s	Sherwood Crescent Manor	Abbotsford

